

BG-50 / BP-30

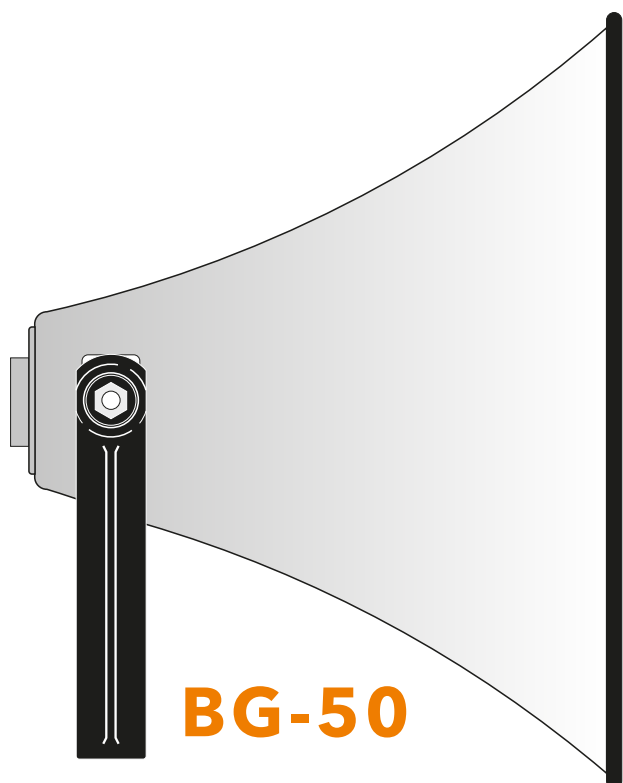

CÂMPANULA



BG-50

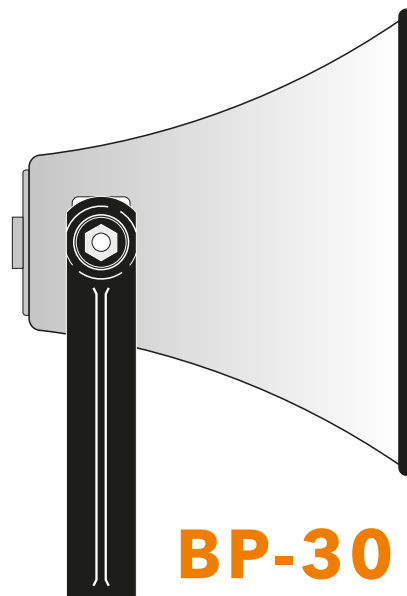

BP-30

CÂMPANULA

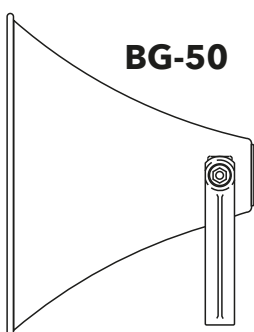

BG-50

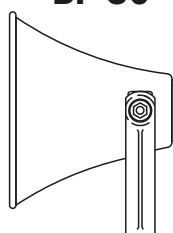

BP-30

PINHA

SD-40T
Membrana
MSD-40T

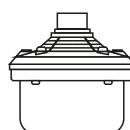

SD-60T
Membrana
MSD-60T

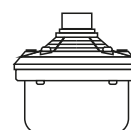

SD-40
Membrana
MS-40



Câmpanula: BG-50
Driver: SD-40T / SD-60T

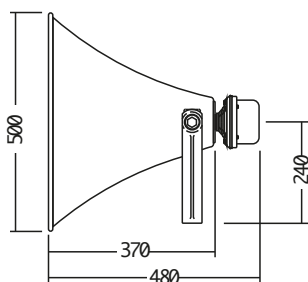

Câmpanula: BP-30
Driver: SD-40T

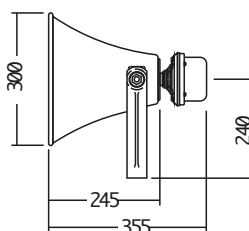

Câmpanula: BG-50
Driver: SD-40

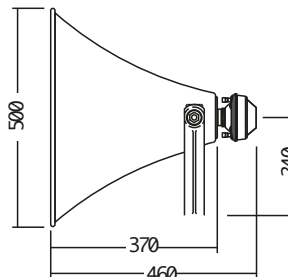

Câmpanula: BP-30
Driver: SD-40

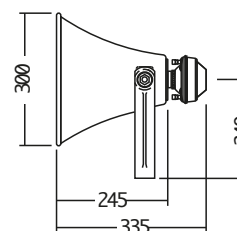

MONTAGEM

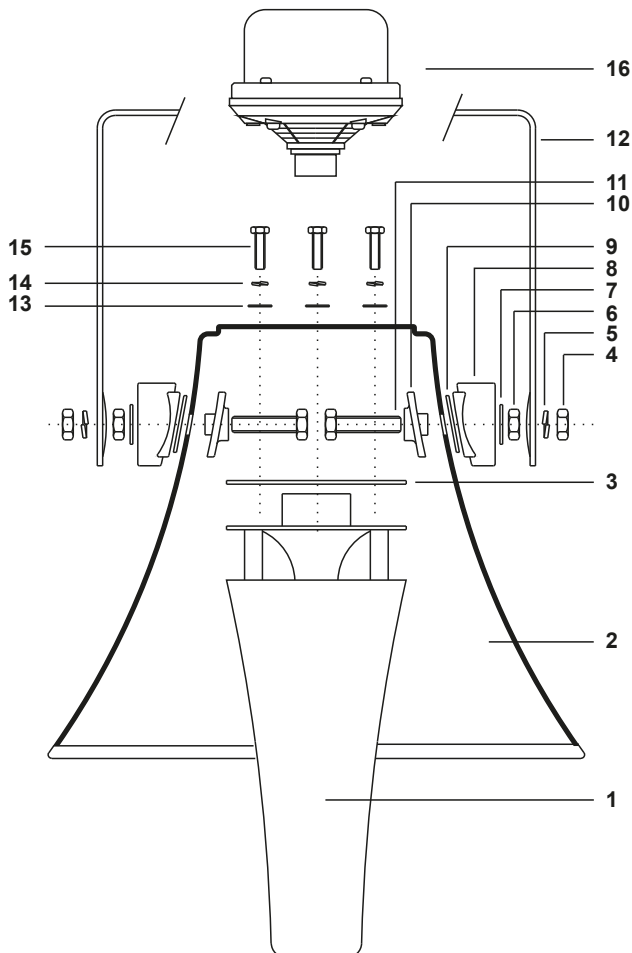
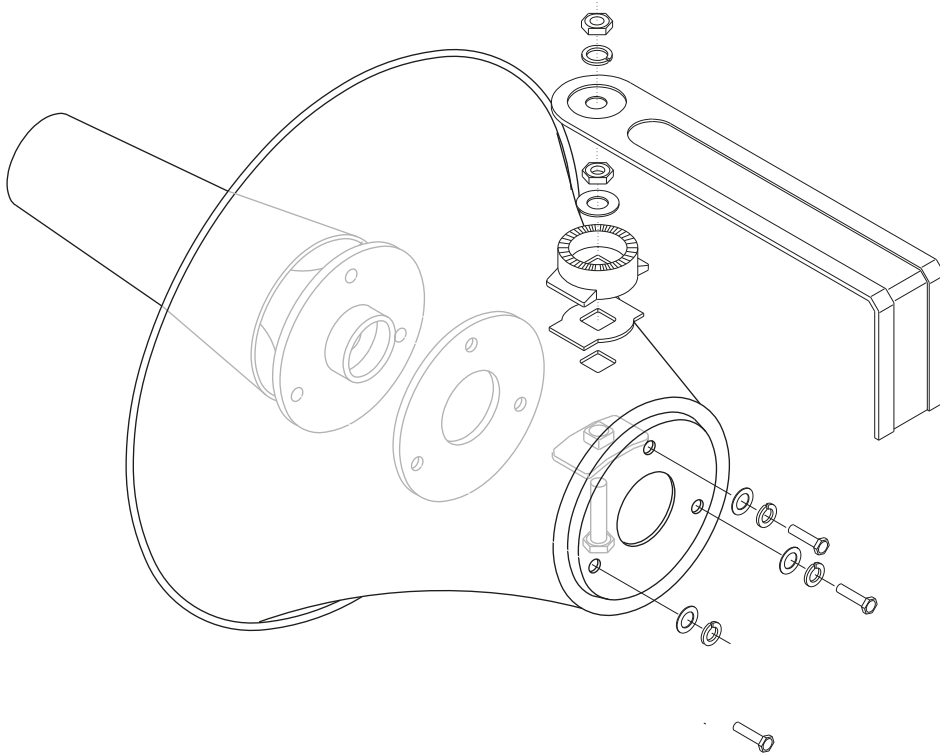

MONTAGEM DO CONJUNTO

Ferramentas necessárias:
 - chave de 10
 - chave de 14

1. Insira o parafuso (11) no suporte interno (10).
2. Encaixe este conjunto no orifício quadrado da corneta.
3. Coloque o vedante de borracha (9), o suporte externo (8), a anilha (7), porca (6) e aperte.
4. Repita o procedimento no lado oposto da corneta.
5. Monte o cone (1) utilizando a gaxeta (3), os vedantes planos (13), a anilha (14) e o parafuso (15), cuidando para que o logo da UDE fique alinhado. Aperte.
6. Coloque o flange de fixação (12) e prenda-o com uma anilha (5) e porca (4) de cada lado sem apertar.
7. Montar a pinha (16).